

# BYS

## Series DC Isolator Switches

Welcome to our website for more information:  
[www.zjbeny.com](http://www.zjbeny.com)



# BYS Series

## DC Isolator Switches

- 1 Brand
- 2 Type
- 3 OFF
- 4 Application Category
- 5 Insulation voltage
- 6 Rated impulse withstand voltage
- 7 Rated Current
- 8 ON
- 9 Certificate Symbol
- 10 Knob
- 11 Standard Code



### Application

**BENY** BYS series DC isolator switch for PV system. Rated current is 5A to 63A, Rated working voltage is 600V to 1500V. Double design can match with many wire ways. Mounting: Standard Din Rail/Panel mounting/Fix installation



### Type Instruction

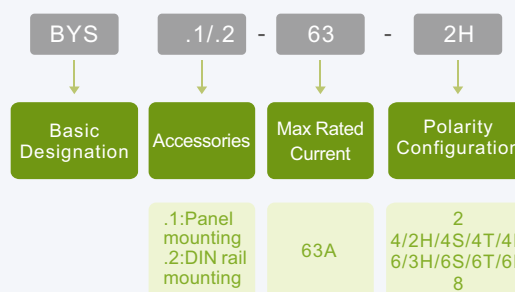

Technical data	Symbol	Merit	Unit
Rated operational voltage (DC poles)	Ue		V DC
Rated operational current (DC poles)	Ie		A DC
Conventional free air thermal current	Ith	63	A
Rated impulse withstand voltage	Uimp	8	kV
Rated short-time withstand current (1s)	Icw	8	kA
Rated short-circuit making capacity	Icm	8	kA
Rated conditional short-circuit current		8	kA
Standard Short Circuit Rating		5	kA
High-Fault Short Circuit Rating		8	kA
Insulation voltage	Ui	1500	V
Utilization category DC	DC-21B		
Number of cycles of operation (With current)	3000 times (6T Type is 2200 times only)		
Number of cycles of operation (Without current)	7000		
Number of DC poles		1/2/3/4/6/8	
Method of mounting	Panel mounting/Standard TH35-7.5 DIN rail mounting		
Method of operation	independent manual operation		
Knob operation force		max.	1.4 Nm
Tightening torque terminal screws M4, min. - max. M4		1.2	1.8 Nm
Tightening torque panel mounting nut, min. - max.		1.0	1.5 Nm
Tightening torque M3 screw in the standard black knob, min. - max.		0.5	0.7 Nm
Ambient temperature allowed between		-40to+70 °C	
Storage temperature allowed between		-40to+80 °C	
Maximum relative humidity, without condensation at 20 °C		90 %	
Pollution degree		2	
IP rating terminals		IP20	
IP rating gland of the shaft in case of single hole panel mounting		IP66	

# BYS.1 DC Isolator Switches

- Panel Mounting
- Compact Structure
- Arcing time < 3ms
- Busbar Design, Easy Installation
- Flame-Retardant
- Modular Design
- Non polarity
- IEC60947-3 Standard
- 2P,4P,6P,8P
- DC-21B/Ui:1500V/Uimp:8kV
- NAME Type 4X Handle



Welcome to our website for more information:  
[www.zjbeny.com](http://www.zjbeny.com)



Leading Manufacturer for  
PV Solution

## Wiring Diagram

Contact Configuration	DC-21B Rating						UL Ratings UL508i			Poles in series	Number of Strings	Type Number	Weight kg/pcs
	600V	800V	900V	1000V	1200V	1500V	500V	600V	1000V				
	12A	8A	6A	4A						2	1	BYS.1-63-2	0.18
		25A	20A	16A	16A	5A	32A	25A		2	1	BYS.1-63-2	0.18
	20A	16A	13A	11A	9A	3A				2	2	BYS.1-63-3	0.18
	50A							45A		2	1	BYS.1-63-2H	0.26
	32A	23A		16A	10A	5A	32A	25A		2	2	BYS.1-63-4	0.26
	40A	40A		40A	32A	16A	32A	32A	32A	4	1	BYS.1-63-4S	0.26
	40A	40A		40A	32A	16A	32A	32A	32A	4	1	BYS.1-63-4B	0.26
	32A	32A		32A	32A	16A	32A	32A	32A	4	1	BYS.1-63-4T	0.26
	32A	23A		16A	10A	5A	32A	25A		2	3	BYS.1-63-6	0.33
	63A							50A		2	1	BYS.1-63-3H	0.33
	32A	32A		32A	32A	32A	40A	40A	40A	6	1	BYS.1-63-6S	0.33
	32A	32A		32A	32A	32A	40A	40A	40A	6	1	BYS.1-63-6B	0.33
	40A	40A		40A			32A	25A	20A	3	2	BYS.1-63-6T	0.33
	32A	23A	20A	16A	10A	5A	32A	25A		2	4	BYS.1-63-8	0.4
		63A						58A		4	1	BYS.1-63-4H	0.4

## Switching Configurations

Type	1-pole	2-pole	3-pole	2-pole 4Parlleled poles	4-pole	2-pole with Input on top Output bottom	2-pole with Input and Output bottom	2-pole with Input and Output on top
Part Number	BYS.1-63-1	BYS.1-63-2	BYS.1-63-3	BYS.1-63-2H	BYS.1-63-4	BYS.1-63-4S	BYS.1-63-4B	BYS.1-63-4T
Contacts Wiring diagram								
Switching example								

Type	6-pole	2-pole 6Parlleled poles	2-pole with Input on top Output bottom	2-pole with Input and Output bottom	4-pole with Input and Output bottom	8-pole	2-pole 8Parlleled poles
Part Number	BYS.1-63-6	BYS.1-63-3H	BYS.1-63-6S	BYS.1-63-6B	BYS.1-63-6T	BYS.1-63-8	BYS.1-63-4H
Contacts Wiring diagram							
Switching example							

## Bus-barwire A and Bus-barwire A for series and parallel switching of contacts

Type	Weight	
Bus-barwire A	2.9g/pc	
Bus-barwire B	2.9g/pc	

## WIRING RATINGS

Wires per pole	Conductor material	Wire size(AWG)	Wire size(mm <sup>2</sup> )	Torque
1	Copper (Cu)	14 AWG-8 AWG, Stranded	2.5mm <sup>2</sup> ~10.0mm <sup>2</sup>	1.2N`m~1.8N`m

## Dimensions(mm)

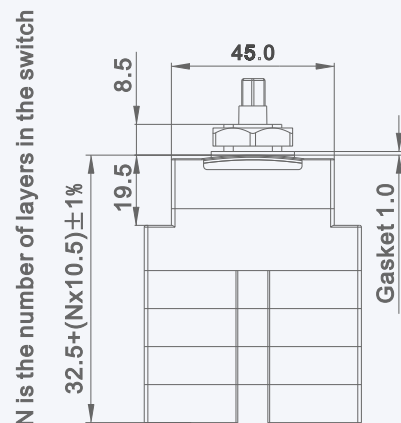
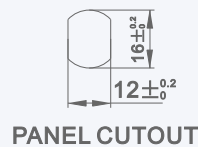
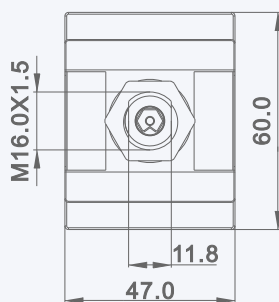



# BYS.2 DC Isolator Switches

- Din Rail Mounting And Fixed Mounting
- Compact Structure
- Arcing Time < 3ms
- Busbar Design, Easy Installation
- Flame Resistance
- Modular Design
- Non polarity
- IEC60947-3 Standard
- 2P, 4P, 6P,8P
- DC-21B/Ui:1500V/Uimp:8kV



Welcome to our website for more information:  
[www.zjbeny.com](http://www.zjbeny.com)



Leading Manufacturer for  
PV Solution

## Wiring Diagram

Contact Configuration	DC-21B Rating						UL Ratings UL508i			Poles in series	Number of Strings	Type Number	Weight kg/pcs
	600V	800V	900V	1000V	1200V	1500V	500V	600V	1000V				
		25A	20A	16A	16A	5A	32A	25A		2	1	BYS.2-63-2	0.17
	50A							45A		2	1	BYS.2-63-2H	0.25
	32A	23A		16A	10A	5A	32A	25A		2	2	BYS.2-63-4	0.25
	40A	40A		40A	32A	16A	32A	32A	32A	4	1	BYS.2-63-4S	0.25
	40A	40A		40A	32A	16A	32A	32A	32A	4	1	BYS.2-63-4B	0.25
	32A	32A		32A	32A	16A	32A	32A	32A	4	1	BYS.2-63-4T	0.25
	32A	23A		16A	10A	5A	32A	25A		2	3	BYS.2-63-6	0.32
	63A							50A		2	1	BYS.2-63-3H	0.32
	32A	32A		32A	32A	32A	40A	40A	40A	6	1	BYS.2-63-6S	0.32
	32A	32A		32A	32A	32A	40A	40A	40A	6	1	BYS.2-63-6B	0.32
	40A	40A		40A			32A	25A	20A	3	2	BYS.2-63-6T	0.32
	32A	23A	20A	16A	10A	5A	32A	25A		2	4	BYS.2-63-8	0.4
		63A						58A		4	1	BYS.2-63-4H	0.4

## Switching Configurations

Type	2-pole	2-pole 4Parlleled poles	4-pole	2-pole with Input on top Output bottom	2-pole with Input and Output bottom	2-pole with Input and Output on top
Part Number	BYS.2-63-2	BYS.2-63-2H	BYS.2-63-4	BYS.2-63-4S	BYS.2-63-4B	BYS.2-63-4T
Contacts Wiring diagram						
Switching example						

Type	6-pole	2-pole 6Parlleled poles	2-pole with Input on top Output bottom	2-pole with Input and Output bottom	4-pole with Input and Output bottom	8-pole	2-pole 8Parlleled poles
Part Number	BYS.2-63-6	BYS.2-63-3H	BYS.2-63-6S	BYS.2-63-6B	BYS.2-63-6T	BYS.2-63-8	BYS.2-63-4H
Contacts Wiring diagram							
Switching example							

## Bus-barwire A and Bus-barwire A for series and parallel switching of contacts

Type	Weight	
Bus-barwire A	2.9g/pc	
Bus-barwire B	2.9g/pc	

## WIRING RATINGS

Wires per pole	Conductor material	Wire size(AWG)	Wire size(mm <sup>2</sup> )	Torque
1	Copper (Cu)	14 AWG-8 AWG, Stranded	2.5mm <sup>2</sup> ~10.0mm <sup>2</sup>	1.2N·m~1.8N·m

## Dimensions(mm)

